



Recent Additions to HYPLOT Labeling

By Joseph Adamski

An imminent addition to HYPLOT that I have been working on is the ability to plot WGS84, Latitude and Longitude, and Projection Grid labels on the inside of the borders. Some of you may just prefer the look, but this is particularly useful for individuals who want to use a border with content around the outside. Figure 1 is an example of the clashing that can occur between borders and outside labels.

FIGURE 1. IHO Border with XY Outside

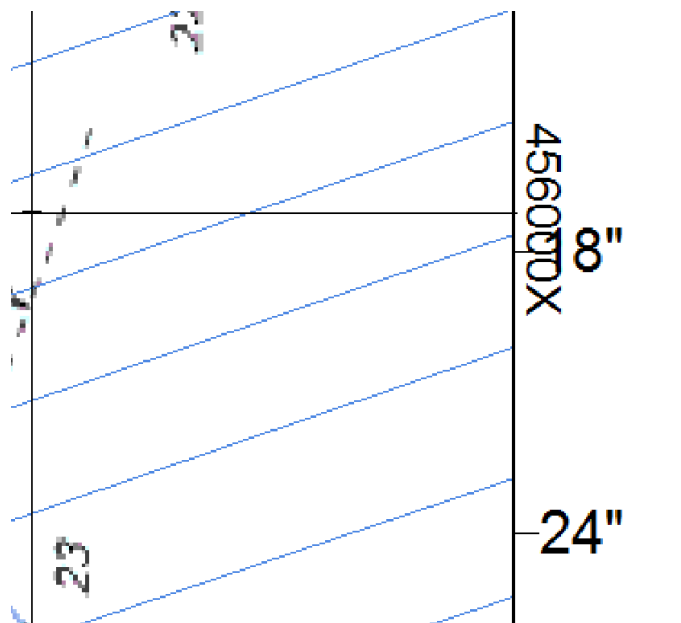

To turn on the inside plotting, check Inside option in the appropriate Grid tab in the HYPLOT Settings dialog (See Figure 2). The inside labels also acknowledge any changes you make to the settings such as font size or tic length.

FIGURE 2. Additional Check Box in the Settings

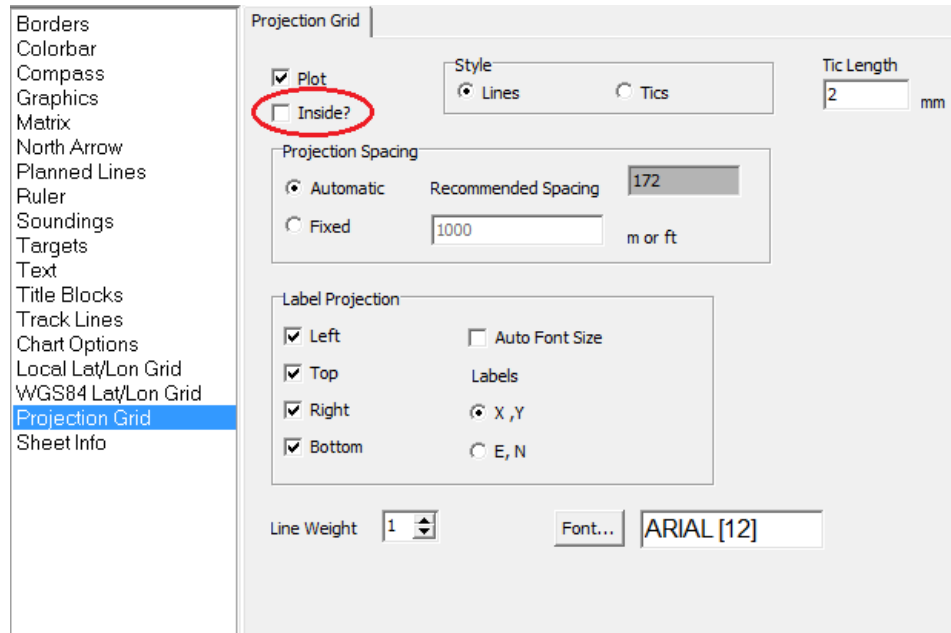

FIGURE 3. An Example of XY Labels that have been Plotted Inside:

