



# 3872 (WW05) Series

Submersible sewage pumps



The 3872 (WW05) Series, like all vortex pumps, minimizes clogs by keeping a safe distance between pumped solids and the impeller. Stringy solids are less likely to bind up the product, which will save on service costs. Featuring a 2" NPT discharge and 2" solids handling, this "Complete. Reliable. Blue." pump is a great option for residential sewage systems.

## Applications

- Residential sewage systems
- Dewatering
- Water transfer
- Anywhere waste or drainage must be disposed of quickly, quietly and efficiently

## Features

- Impeller is glass-filled thermoplastic full-vortex design with pump out vanes for mechanical seal protection
- Casing and base are rugged glass-filled thermoplastic design – provides superior strength and corrosion resistance
- Cast iron motor housing for efficient heat transfer, strength and durability
- Thermoplastic motor cover with integral handle and float switch attachment points
- Upper and lower heavy duty ball bearing construction
- Three (3) year standard warranty/Four (4) year GPDA

## Product specifications

Order number	HP	Volts	Amps	Minimum circuit breaker	Phase	Float switch style	Cord length	Discharge connection	Minimum on level	Minimum off level	Minimum basin diameter	Maximum solids size	Shipping weight lbs (kgs)
WW0511	.5	115	13	20	1	Plug / no switch	10'	2"	Manual	Manual	18"	2"	22 (10)
WW0511A						Piggyback / wide-angle	10'		15"	9"			23 (10.4)
WW0511AC						Piggyback / wide-angle	20'		15"	9"			23 (10.4)
WW0512F	230	6.5	10			Plug / no switch	20'		Manual	Manual			22 (10)

## Performance curve

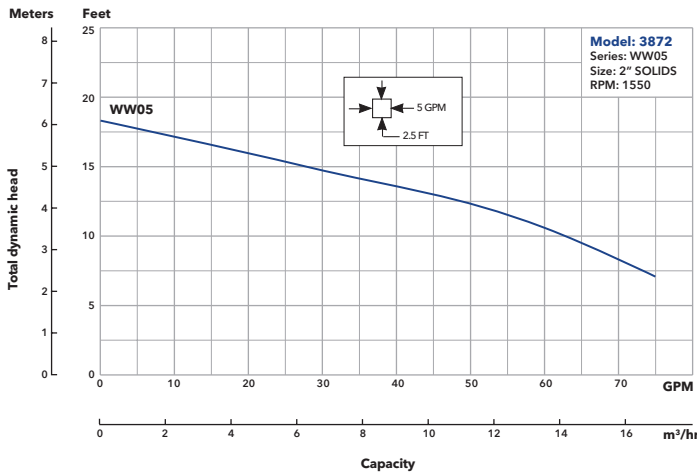

## Dimensions

(All dimensions are in inches. Do not use for construction purposes.)

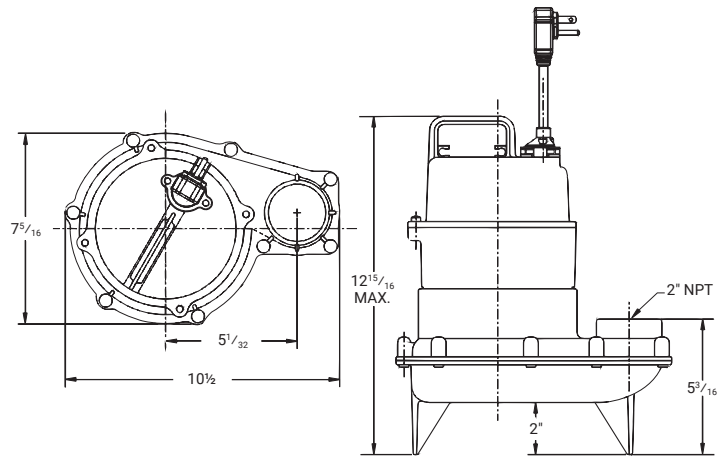

## Agency listings



Tested to UL778 CAN 22.2 by CSA International  
(Canadian Standards Association)

Learn more  
about 3872  
pumps



**COMPLETE.  
RELIABLE. BLUE.**

Learn more about  
our complete line  
of wastewater  
products.



## Materials of construction

Part name	Material
Impeller	Thermoplastic
Casing and base	Thermoplastic
Motor housing	Cast iron
Cord	SJTW
Mechanical switch	cURus listed, 13A, 115V
Fasteners	Stainless steel
Handle	Thermoplastic



Xylem Inc. [www.xylem.com/goulds](http://www.xylem.com/goulds)

This information is subject to change without notice. All information presented herein is believed reliable and in accordance with accepted engineering practices. Xylem makes no warranties as to the completeness of this information. Users are responsible for evaluating individual product suitability for specific applications. Xylem assumes no liability whatsoever for any special, indirect or consequential damages arising from the sale, resale or misuse of its products.

©2025 Xylem is a registered trademark of Xylem Inc. or one of its subsidiaries. Goulds Water Technology is a registered trademark of ITT Manufacturing Enterprises LLC and is used under license. All other trademarks or registered trademarks are the property of their respective owners.

GWT3872WW-SS-120071 R2 11/2025

**xylem**  
Let's Solve Water