

JOB:	REPRESENTATIVE:	
UNIT TAG:	ORDER NO.	DATE:
ENGINEER:	SUBMITTED BY:	DATE:
CONTRACTOR:	APPROVED BY:	DATE:

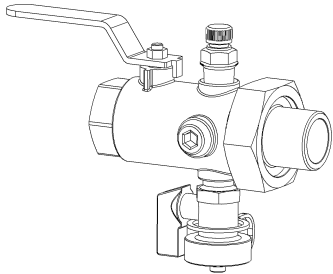

Model UBV Shut-Off Valve

DESCRIPTION

The Bell & Gossett UBV is a combination full port shut-off valve and union for use in HVAC systems. Valves are furnished standard with a hose and drain valve for servicing, one pressure / temperature port for commissioning, and one plugged 1/4" tap. A variety of pipe connections are available on both the fixed and union ends.

CONSTRUCTION

- Body: Brass C37000
- Ball: Chrome Plated
- Ball Seal: Teflon[®]
- Stem: Explosion Proof
- O-Rings: EPDM
- Handle: Chrome Plated Steel with Plastic Cover
- Taps: 3 Total - 1/4" NPT
 - 1 - Plugged
 - 1 - Drain Valve
 - 1 - Pressure / Temperature Port

MAXIMUM WORKING PRESSURE

400 psig (2,758 kPa)

MAXIMUM OPERATING TEMPERATURE

-4°F (-20°C) to 250°F (121°C)

* Teflon[®] is a registered trademark of E.I. DuPont de Nemours and Company.

SCHEDULE

VALVE SIZE FIXED END	TAGGING INFORMATION	QUANTITY
1/2" Sweat Female		
1/2" NPT Female		
3/4" Sweat Female		
3/4" NPT Female		
1" Sweat Female		
1" NPT Female		
1 1/4" Sweat Female		
1 1/4" NPT Female		
1 1/2" Sweat Female		
1 1/2" NPT Female		
2" Sweat Female		
2" NPT Female		

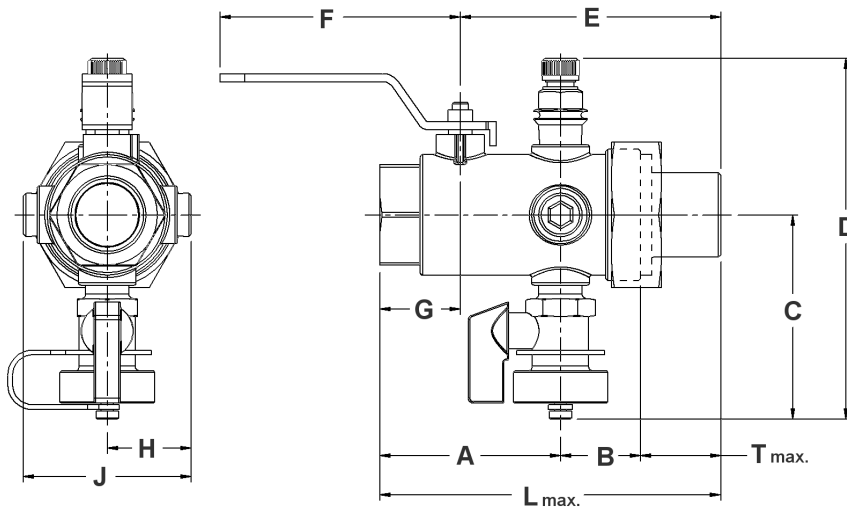

Valve Size Fixed End	Connection Fixed End	DIMENSIONS* INCH (mm)											Approx. Weight Lbs.
		A	B	C	D	E	F	G	H	J	T (Max)	L (Max)	
½"	Sweat Female	2.02 (51.3)	0.40 (10.2)	2.525 (64.1)	4.58 (116.2)	3.54 (89.9)	3.38 (85.7)	1.03 (26.3)	0.90 (22.9)	1.81 (45.8)	1.55 (39.4)	3.97 (100.9)	1.6 (0.7)
½"	NPT Female	2.00 (50.9)	0.40 (10.2)	2.525 (64.1)	4.58 (116.2)	3.54 (89.9)	3.38 (85.7)	1.02 (25.8)	0.90 (22.9)	1.81 (45.8)	1.55 (39.4)	3.95 (100.5)	1.6 (0.7)
¾"	Sweat Female	2.67 (67.7)	0.66 (21.8)	2.76 (70.1)	5.05 (128.1)	3.79 (96.3)	3.50 (88.9)	1.45 (36.9)	1.14 (28.9)	2.28 (57.8)	1.55 (39.4)	5.08 (128.9)	1.9 (0.9)
¾"	NPT Female	2.43 (61.8)	0.86 (21.8)	2.76 (70.1)	5.05 (128.1)	3.79 (96.3)	3.50 (88.9)	1.22 (30.9)	1.14 (28.9)	2.28 (57.8)	1.55 (39.4)	4.84 (123)	1.9 (0.9)
1"	Sweat Female	2.69 (68.4)	0.88 (22.4)	2.763 (70.2)	5.05 (128.2)	4.14 (105.2)	4.00 (101.6)	1.43 (36.2)	1.14 (29)	2.28 (57.9)	2.00 (50.8)	5.57 (141.6)	2.9 (1.3)
1"	NPT Female	2.35 (59.7)	0.88 (22.4)	2.763 (70.2)	5.05 (128.2)	4.14 (105.2)	4.00 (101.6)	1.08 (27.5)	1.14 (29)	2.28 (57.9)	2.00 (50.8)	5.23 (132.9)	2.9 (1.3)
1½"	Sweat Female	3.56 (90.5)	1.09 (27.7)	3.141 (79.8)	5.81 (147.5)	4.94 (125.5)	5.38 (136.5)	1.71 (43.5)	1.52 (38.6)	3.04 (77.1)	2.00 (50.8)	5.23 (169)	3.9 (1.8)
1½"	NPT Female	3.30 (83.7)	1.09 (27.7)	3.141 (79.8)	5.81 (147.5)	4.94 (125.5)	5.38 (136.5)	1.45 (36.7)	1.52 (38.6)	3.04 (77.1)	2.00 (50.8)	6.39 (162.2)	3.9 (1.8)
1½"	Sweat Female	4.36 (110.7)	1.12 (28.4)	3.42 (86.9)	6.37 (161.7)	5.76 (146.3)	5.50 (139.7)	2.25 (57)	1.80 (45.7)	3.60 (91.3)	2.52 (64)	8.00 (203.1)	5.2 (2.4)
1½"	NPT Female	4.01 (102)	1.12 (28.4)	3.42 (86.9)	6.37 (161.7)	5.76 (146.3)	5.50 (139.7)	1.90 (48.3)	1.80 (45.7)	3.60 (91.3)	2.52 (64)	7.65 (194.4)	5.2 (2.4)
2"	Sweat Female	4.72 (119.9)	1.21 (30.7)	3.685 (93.6)	6.90 (175.1)	6.97 (177.0)	6.00 (152.4)	2.10 (53.4)	2.06 (52.4)	4.13 (104.8)	3.14 (79.8)	9.07 (230.4)	7.7 (3.5)
2"	NPT Female	4.20 (106.7)	1.21 (30.7)	3.685 (93.6)	6.90 (175.1)	6.97 (177.0)	6.00 (152.4)	1.59 (40.3)	2.06 (52.4)	4.13 (104.8)	3.14 (79.8)	8.55 (217.2)	7.7 (3.5)

*All dimensions +/- 0.125 (3.2 mm) tolerance. Dimensions are subject to change. Not to be used for construction purposes unless certified.

Xylem Inc.
 8200 N. Austin Avenue
 Morton Grove, IL 60053
 Phone: (847)966-3700
 Fax: (847)965-8379
 www.bellgossett.com



Bell & Gossett is a trademark of Xylem Inc. or one of its subsidiaries.
 © 2013 Xylem Inc.