

<b>JOB:</b>	<b>REPRESENTATIVE:</b>	
<b>UNIT TAG:</b>	<b>ORDER NO.:</b>	<b>DATE:</b>
<b>ENGINEER:</b>	<b>SUBMITTED BY:</b>	<b>DATE:</b>
<b>CONTRACTOR:</b>	<b>APPROVED BY:</b>	<b>DATE:</b>

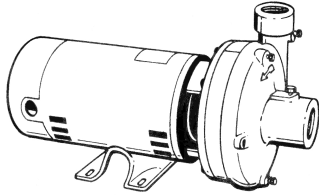

## Series 1535

### Close-Coupled Centrifugal Pumps

**FEATURES**

- Bronze Fitted Construction
- Cast Iron Volute
- Brass Impeller

**TYPE OF SEAL**

- Standard Seal  
Buna-Carbon/Ceramic  
0°F to +225°F  
(-18°C to +107°C)

**WORKING PRESSURE**

- 175 psi (12 bar) W.P.

**SCHEDULE**

MODEL NUMBER	PART NUMBER	VOLTAGE	PHASE	CYCLE	TAGGING INFORMATION	QUANTITY
351S	168021	115/230	1	60		
352S	168023	115/230	1	60		
353S	168025	115/230	1	60		
354S	168027	115/230	1	60		
355S	168029	115/230	1	60		
357S	168034	115/230	1	60		
358S	168036	115/230	1	60		
351T	168022	208-230/460	3	60		
352T	168024	208-230/460	3	60		
353T	168026	208-230/460	3	60		
354T	168028	208-230/460	3	60		
355T	168031	208-230/460	3	60		
356T	168033	208-230/460	3	60		
357T	168035	208-230/460	3	60		
358T	168038	208-230/460	3	60		
359T	168040	208-230/460	3	60		
3510T	168042	208-230/460	3	60		
3511T	168044	208-230/460	3	60		

All single phase motors have built-in overload protection. Motors are Open Dripproof.  
 Model numbers ending in "S" are single phase  
 Model numbers ending in "T" are three phase

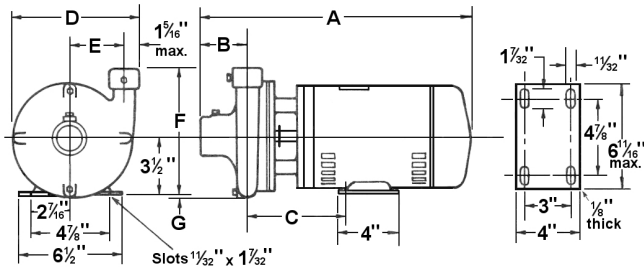
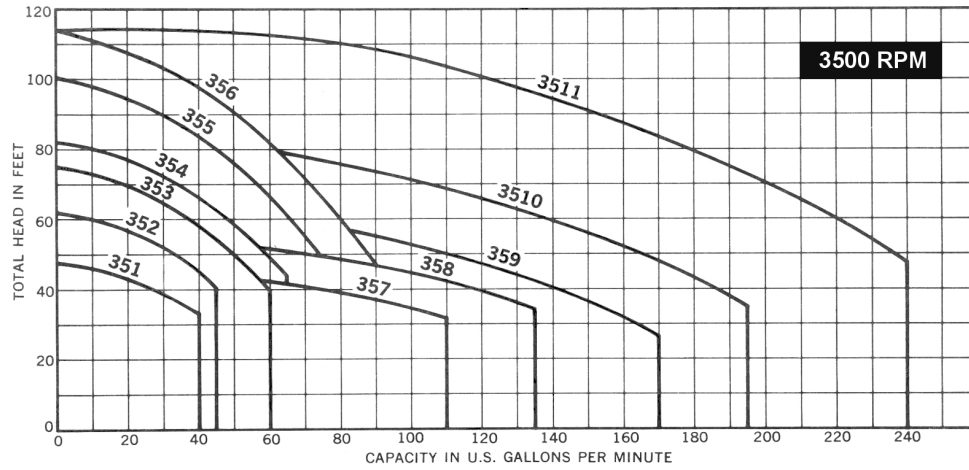

MODEL NO.	HP	DIMENSIONS IN INCHES (MM)								
		Suction	Discharge	A (MAX.)	B	C	D	E	F	G
351S	1/3	1-1/4 (32)	1 (25)	14-3/4 (375)	2-15/16 (75)	5-5/16 (135)	8 (203)	3-3/8 (86)	8 (203)	1/4 (6)
351T	1/3	1-1/4 (32)	1 (25)	15 (381)	2-15/16 (75)	5-5/16 (135)	8 (203)	3-3/8 (86)	8 (203)	1/4 (6)
352S	1/2	1-1/4 (32)	1 (25)	15 (381)	2-15/16 (75)	5-5/16 (135)	8 (203)	3-3/8 (86)	8 (203)	1/4 (6)
352T	1/2	1-1/4 (32)	1 (25)	15 (381)	2-15/16 (75)	5-5/16 (135)	8 (203)	3-3/8 (86)	8 (203)	1/4 (6)
353S	3/4	1-1/4 (32)	1 (25)	15-1/2 (394)	2-15/16 (75)	5-5/16 (135)	8 (203)	3-3/8 (86)	8 (203)	1/4 (6)
353T	3/4	1-1/4 (32)	1 (25)	15-1/2 (394)	2-15/16 (75)	5-5/16 (135)	8 (203)	3-3/8 (86)	8 (203)	1/4 (6)
354S	1	1-1/4 (32)	1 (25)	15-3/4 (400)	2-15/16 (75)	5-5/16 (135)	8 (203)	3-3/8 (86)	8 (203)	1/4 (6)
354T	1	1-1/4 (32)	1 (25)	16 (406)	2-15/16 (75)	5-5/16 (135)	8 (203)	3-3/8 (86)	8 (203)	1/4 (6)
355S	1-1/2	1-1/4 (32)	1 (25)	16-15/16 (430)	2-15/16 (75)	5-5/16 (135)	8 (203)	3-3/8 (86)	8 (203)	1/4 (6)
355T	1-1/2	1-1/4 (32)	1 (25)	16-7/16 (418)	2-15/16 (75)	5-5/16 (135)	8 (203)	3-3/8 (86)	8 (203)	1/4 (6)
356T	2	1-1/4 (32)	1 (25)	16-7/16 (418)	2-15/16 (75)	5-5/16 (135)	8 (203)	3-3/8 (86)	8 (203)	1/4 (6)
357S	1	2 (51)	1-1/2 (38)	16 (406)	2-15/16 (75)	5-9/16 (141)	8-3/8 (213)	3-3/8 (86)	8-3/4 (222)	1/2 (13)
357T	1	2 (51)	1-1/2 (38)	16-1/4 (413)	2-15/16 (75)	5-9/16 (141)	8-3/8 (213)	3-3/8 (86)	8-3/4 (222)	1/2 (13)
358S	1-1/2	2 (51)	1-1/2 (38)	17-3/16 (437)	2-15/16 (75)	5-9/16 (141)	8-3/8 (213)	3-3/8 (86)	8-3/4 (222)	1/2 (13)
358T	1-1/2	2 (51)	1-1/2 (38)	16-11/16 (424)	2-15/16 (75)	5-9/16 (141)	8-3/8 (213)	3-3/8 (86)	8-3/4 (222)	1/2 (13)
359T	2	2 (51)	1-1/2 (38)	16-11/16 (424)	2-15/16 (75)	5-9/16 (141)	8-3/8 (213)	3-3/8 (86)	8-3/4 (222)	1/2 (13)
3510T	3	2 (51)	1-1/2 (38)	17-3/16 (437)	2-15/16 (75)	5-9/16 (141)	8-3/8 (213)	3-3/8 (86)	8-3/4 (222)	1/2 (13)
3511T	5	2 (51)	1-1/2 (38)	18-11/16 (475)	2-15/16 (75)	5-9/16 (141)	8-3/8 (213)	3-3/8 (86)	8-3/4 (222)	1/2 (13)

Dimensions are subject to change. Not to be used for construction purposes unless certified.

