

xylem

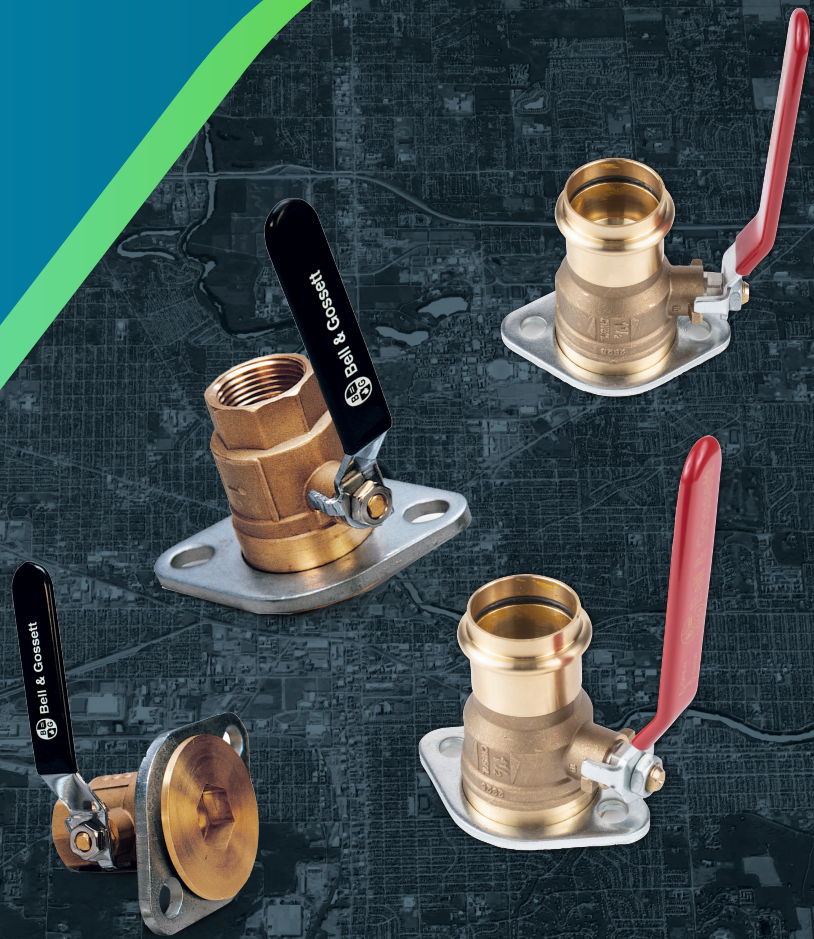

Isolation Flanges

Isolation flanges combine a circulator flange and ball valve to allow the circulator to be isolated from the system for quick and easy removal. Free-floating flanges eliminate the need to align flanges, making pump installation a snap and service or replacement of the circulator simple without the need to drain the

system. Lead-free* brass and non-ferrous wetted internal components make the isolation flanges ideal for hydronic heating systems. Capscrews and nuts are included, and the isolation flange fits Xylem's Bell & Gossett ecocirc® 20-18, ecocirc XL, NRF/NBF/SSF wet rotors, Series PL, Series 100, HV, PR and LR circulators.

Featuring press connect fittings. Faster. Easier. Safer.

 **Bell & Gossett**
xylem

Isolation Flanges

Typical specifications

Furnish and install on plans _____ inches NPT/Sweat x Flange Isolation Flanges each side of the circulator(s). When closed, the isolation flanges isolate the circulator from the rest of the system so the system does not need to be drained when removing the circulator. The isolation valve shall be constructed with a brass body, chrome plate brass ball, chrome plated steel flange and handle, and Teflon packing and seat ring. The mating flange shall be free floating allowing it to rotate eliminating the need to align the bolt holes of the flanges when installing to the system piping. The isolation flange shall be Xylem Bell & Gossett or equal.

Available sizes: 3/4", 1" 1 1/4" & 1 1/2" (refer to Dimensions and Weights table for details)

Operating data

Maximum working pressure 150 psi (10 bar)
 Maximum operating temperature 250°F (121°C)

Materials of construction

Valve body Lead-free* brass
 Flange Chrome plated steel
 Ball Chrome plated lead-free* brass
 Packing Teflon®**
 Seat ring Teflon
 Stem Lead-free* brass

* CSA certified to NSF/ANSI 372 that product contains less than 0.25% lead content by weight on wetted surface

** Teflon is a registered trademark of E.I. du Pont de Nemours and Company

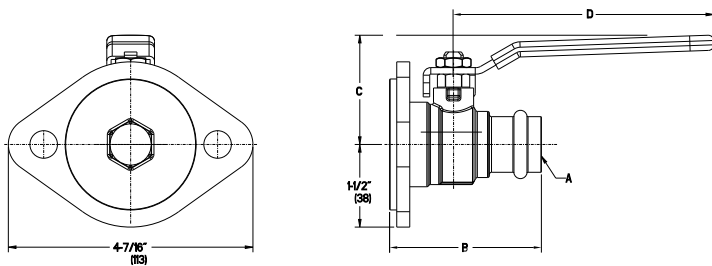

Dimensions and weights

Part no.	Model	Size (inches)	Use with the following circulators	DIMENSIONS – inches (mm)				Approx. shipping wt. lbs. (Kg)
				A	B	C	D	
101221LF	IF-3/4	3/4" NPTI X FL	ecocirc 20-18/ ecocirc+ 20-18	3/4" NPTI	2-27/64" (61.5)	2" (50.5)	4-23/32" (120.0)	3.4 (1.5)
101222LF	IF-1	1" NPTI X FL		1" NPTI	2-57/64" (73.3)	2-5/32" (54.7)	4-23/32" (120.0)	4.4 (2.0)
101223LF	IF-1-1/4	1 1/4" NPTI X FL		1 1/4" NPTI	3-19/64" (84.0)	3" (75.9)	6-7/32" (158.0)	6.3 (2.8)
101241LF	IF-1-1/2	1 1/2" NPTI X FL		1 1/2" NPTI	3-23/64" (85.5)	3" (75.9)	6-7/32" (158.0)	6.6 (3.0)
101226LF	IFS-3/4	3/4" SWT X FL	ecocirc XL 20-35, 36-45, 55-45	3/4" SWT	2-41/64" (67.0)	2" (50.5)	4-23/32" (120.0)	3.4 (1.5)
101227LF	IFS-1	1" SWT X FL		1" SWT	3" (75.3)	2-5/32" (54.7)	4-23/32" (120.0)	4.2 (1.9)
101228LF	IFS-1-1/4	1 1/4" SWT X FL		1 1/4" SWT	3-25/64" (86.0)	3" (75.9)	6-7/32" (158.0)	5.9 (2.7)
101243LF	IFS-1-1/2	1 1/2" SWT X FL	Series PL-30, PL-36, PL-55, PL-100 Series 100, PR, and LR	1 1/2" SWT	3-35/64" (90.0)	3" (75.9)	6-7/32" (158.0)	6.5 (3.0)
101255LF	IFP-3/4	3/4" PC X FL	Does not include NRF/NBF-45	3/4" PC	2-3/4" (70)	2" (50.5)	4-23/32" (120)	1.29 (0.59)
101256LF	IFP-1	1" PC X FL		1" PC	3-1/8" (79.4)	2-5/32" (54.7)	4-23/32" (120)	1.62 (0.73)
101257LF	IFP-1-1/4	1 1/4" PC X FL		1 1/4" PC	3-1/2" (89)	3" (75.9)	6-15/64" (158.4)	2.61 (1.18)
101258LF	IFP-1-1/2	1 1/2" PC X FL		1 1/2" PC	3-15/16" (100)	3" (75.9)	6-15/64" (158.4)	2.7 (1.22)

IF = Isolation Flange, NPTI - National Pipe Thread Internal, SWT - Sweat fitting, PC - Press connect, FL - Flange connection



Learn more about Isolation Flanges

Dimensions and weights are approximate and subject to change. Contact factory for certified dimensions. The part numbers and shipping weights are for two isolation flanges, capscrews and nuts.

Xylem Inc.
 8200 N. Austin Avenue
 Morton Grove, Illinois 60053

Phone: (847) 966-3700
 Fax: (847) 965-8379
www.xylem.com/bellgossett



All information presented herein is believed reliable and in accordance with accepted engineering practices. Xylem makes no warranties as to the completeness of this information. Users are responsible for evaluating individual product suitability for specific applications. Xylem assumes no liability whatsoever for any special, indirect or consequential damages arising from the sale, resale or misuse of its products. Subject to change without notice.
 © 2025 Xylem and Bell & Gossett are trademarks of Xylem, Inc. or one of its subsidiaries. All other trademarks are the property of their respective owners.

